

# HALL B

Hall B's retail catering facilities complement its 1815sqm floor space, making it suitable for exhibitions and large banquets.

**TOTAL AREA: 1815M<sup>2</sup> CAPACITY: 1200**



Internal access improvements mean the hall boasts great visitor flow to adjoining event spaces Hall A and Hall C. This hall also has easy access to the Queen's Suite via lift and escalators.

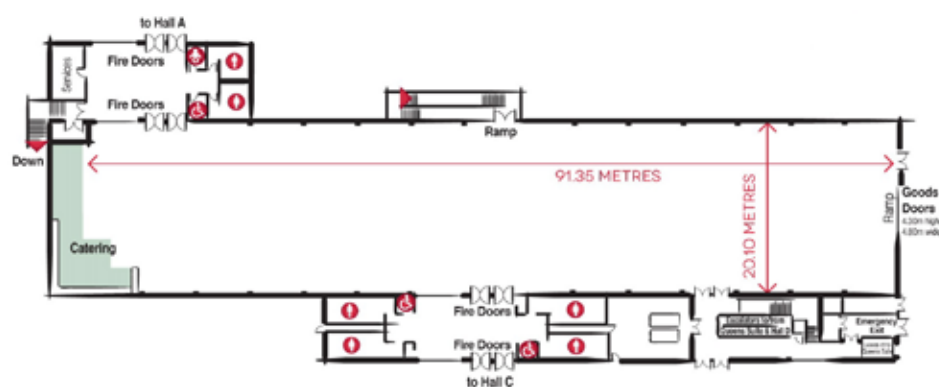

## SPECIFICATION

### Dimensions

<b>TOTAL AREA:</b>	<b>1815M<sup>2</sup></b>
<b>LENGTH:</b>	<b>91.35M</b>
<b>WIDTH:</b>	<b>20.10M</b>
<b>HEIGHT:</b>	<b>2.79 TO 4M</b>

### Access

<b>MAX ACCESS HEIGHT:</b>	<b>4.30M</b>
<b>MAX ACCESS WIDTH:</b>	<b>4.80M</b>
<b>OWN ENTRANCE:</b>	<b>NO</b>

### Capacity Examples

<b>THEATRE STYLE:</b>	<b>1500</b>
<b>CABARET:</b>	<b>980</b>
<b>BANQUET:</b>	<b>1200</b>